



Copyright © 2017  
 Offington Land Surveys Ltd  
 29 Offington Drive  
 Worthing  
 West Sussex BN14 9PW  
 Tel/fax: 01903 287883  
 surveyors@offington.com

JOB  
 XXXX  
 XXXX  
 XXXX

Drawing No. XXXXXXXX Site Plan

Client XXXX

Version: 1.0  
 Publication Date: ---  
 Plot Scale: 1:250  
 Sheet Size: A4 Landscape  
 Sheet: 1 of 2

Survey DWN: ---  
 Surveyor: ST  
 Drawn by: JAV  
 Checked by: ST

STANDARD REFERENCE  
 Datum Used: Newlyn  
 Survey Implemented by: OLS & TSG/2017/171 by non-levelling level in  
 to BS2470:2015 accuracy (2015) accuracy to 10mm over  
 Survey Station Shown Thus:  
 Four Water Drainage  
 Storm Water Drainage  
 Water Mains  
 Gas Mains  
 Electricity Cable  
 British Telecom Cable

The details shown herein relating to all underground services are as  
 obtained by normal above-ground survey observation and methods  
 and where indicated are by reference to available utility records.  
 Although all reasonable efforts have been made no guarantee can be  
 given for the completeness or accuracy of this information.

ABBREVIATIONS  
 RL Bed Level IC Inspection Chamber  
 BT British Telecom IC Level Staff  
 CTR Concrete Roadway P/C Level Staff  
 CB Concrete Buried M4 Manhole  
 CC Chasing Cable CMC Chained Cable  
 CL Cover Level PI Public House  
 CM Cable Marker P2 Public House  
 CP Catch Pit RP Road Sign  
 D Depth  
 EOP Electricity Cable Pit RWP Rain Water Pipe  
 EP Electricity Pole SC Show Clock  
 JRM JRM Box SC Storm Drain  
 FA Fire Alarm SV Stop Valve  
 FI Fire Hydrant SWP Sewer & Vent Pipe  
 FL Floor Level SWF Storm Water  
 EP Footpath ST Street Light  
 G Gully WM Water Meter

FENCES  
 FCB Close Boarded FFM Metal Palisade  
 FCL Chain Link FFP Fence Panel  
 FCP Chain Link FFW Fence Panel  
 FCF Chain Link FFW Fence Panel  
 FCF Chain Link FFW Fence Panel  
 FCF Chain Link FFW Fence Panel  
 FCF Chain Link FFW Fence Panel

STATION SCHEDULE

Station	Easting	Northing	Level (m)
1	XXXX93.281	XXXX60.417	55.348
2	XXXX93.281	XXXX60.417	55.348
3	XXXX93.281	XXXX60.417	55.348
4	XXXX93.281	XXXX60.417	55.348
5	XXXX93.281	XXXX60.417	55.348
6	XXXX93.281	XXXX60.417	55.348
7	XXXX93.281	XXXX60.417	55.348
8	XXXX93.281	XXXX60.417	55.348
9	XXXX93.281	XXXX60.417	55.348
10	XXXX93.281	XXXX60.417	55.348
11	XXXX93.281	XXXX60.417	55.348
12	XXXX93.281	XXXX60.417	55.348
13	XXXX93.281	XXXX60.417	55.348

TREE SCHEDULE

Number	Easting	Northing	Height (m)	Note
T.1	2.5	4	0.6	stump
T.2	2.5	4	0.6	stump
T.3	2.1	12	17	medium
T.4	2.1	12	17	medium
T.5	2.1	12	17	medium
T.6	2.1	12	17	medium
T.7	2.1	12	17	medium
T.8	4.1	8	37	stump
T.9	1.5	12	17	medium
T.10	1.5	12	17	medium
T.11	3.8	18	0.3	stump
T.12	3.8	18	0.3	stump
T.13	0.9	6	8	stump
T.14	0.9	6	8	stump
T.15	0.9	6	8	stump
T.16	0.9	6	8	stump
T.17	0.9	6	8	stump
T.18	0.9	6	8	stump
T.19	0.9	6	8	stump
T.20	0.9	6	8	stump
T.21	1.3	10	17	medium
T.22	1.3	10	17	medium
T.23	1.3	10	17	medium
T.24	1.3	10	17	medium
T.25	1.3	10	17	medium
T.26	1.3	10	17	medium
T.27	1.3	10	17	medium
T.28	1.3	10	17	medium
T.29	1.3	10	17	medium
T.30	1.3	10	17	medium
T.31	1.3	10	17	medium
T.32	1.3	10	17	medium
T.33	1.3	10	17	medium
T.34	1.3	10	17	medium
T.35	1.3	10	17	medium

Tree spread and height are approximate. If listed, species should  
 be registered as assumed unless verified by a qualified expert!

NOTES  
 3D terrain model is shown in CAD layers as follows  
 3D terrain - 3D points (shown as ground level)  
 This 3D surface - includes 3D points (shown as ground level)  
 This 3D surface - 3D surface (shown as ground level)  
 This 3D surface - mesh and located union of 3D surface elements

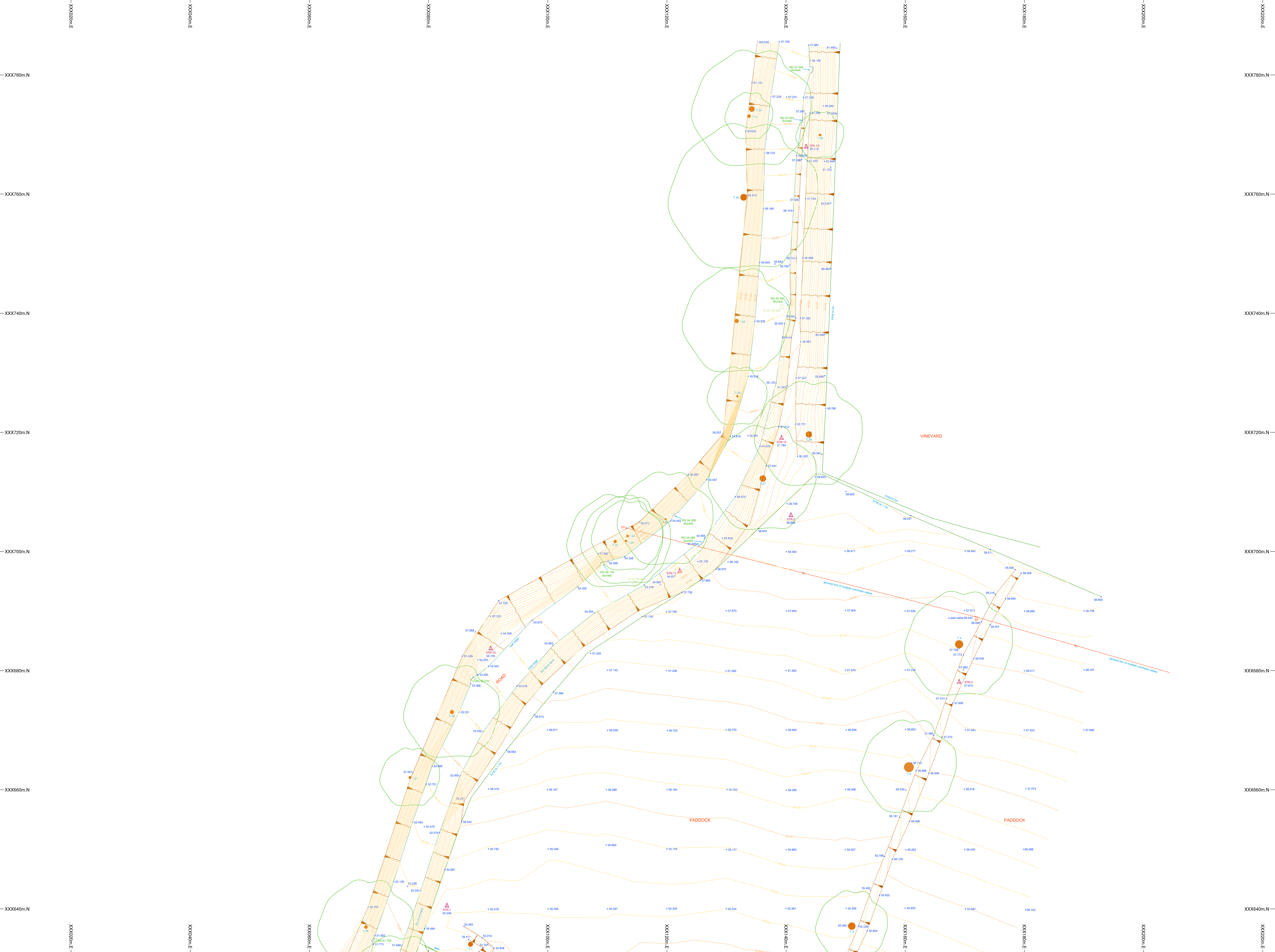
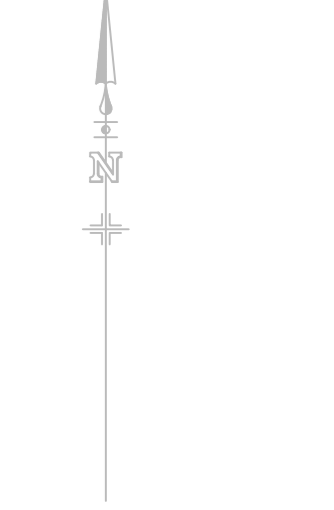
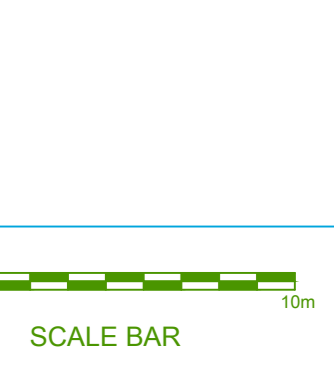

XXX780m.N  
 XXX760m.N  
 XXX740m.N  
 XXX720m.N  
 XXX700m.N  
 XXX680m.N  
 XXX660m.N  
 XXX640m.N

XXXX20m.E  
 XXXX40m.E  
 XXXX60m.E  
 XXXX80m.E  
 XXXX100m.E  
 XXXX120m.E  
 XXXX140m.E  
 XXXX160m.E  
 XXXX180m.E  
 XXXX200m.E  
 XXXX220m.E  
 XXXX240m.E  
 XXXX260m.E  
 XXXX280m.E  
 XXXX300m.E





Copyright © 2017  
 Offington Land Surveys Ltd  
 28 Offington Drive  
 Worthing  
 West Sussex BN14 9PW  
 Tel/Fax 01903 267863  
 surveys@offington.com

Job  
 XXXX  
 XXXX  
 XXXX

Drawing No: XXXXXXXX Site Plan

Client  
 XXXX

Version 1.0  
 Publication Date: 12/200  
 Plot Scale: A3 Landscape  
 Sheet Size: 21x27  
 Date: 12/200  
 Survey Details:  
 Surveyed by: ST  
 Checked by: ST

**STANDARD REFERENCE**  
 Datum Used: Newlyn  
 Survey Method: CON (2003) 10  
 Survey Station Shows True  
 Full Water Drainage  
 Storm Water Drainage  
 Water Mains  
 Gas Mains  
 Electricity Cables  
 British Telecom Cables  
 True north direction shown is indicated only

The details shown herein relating to all underground services are as obtained by normal above ground survey observation and methods and where indicated also by reference to available utility records. Although all reasonable efforts have been made no guarantee can be given for the completeness or accuracy of this information.

**ABBREVIATIONS**

IC	Inspection Chamber	IC	Inspection Chamber
BT	British Telecom	L	Level Line
CC	Concrete Cover	LP	Level Point
CB	Concrete Block	MB	Manhole
CC	Covered Curb	OC	Overhead Cable
CL	Cover Level	PH	Public House
CM	Cable Marker	PO	Post Office
CP	Cable Pin	RS	Road Sign
CS	Cable Street	RIP	Road Iron Pipe
EA	Electricity Pole	SC	Stop Cock
EM	Earth Main	ST	Survey Station
FA	Fire Alarm	SV	Stop Valve
FM	Fire Mains	SW	Set & Wnd Pipe
FL	Flow Level	SW	Storm Waste
FP	Footpath	TF	Telephone Pole
G	Gully	WM	Water Meter

**FENCES**

FCW	Chain Fencing	FFW	Field Fence
FL	Chain Link	FFP	Field Post
FCW	Chain Fencing	FFW	Field Fence
FCW	Chain Fencing	FFW	Field Fence
FCW	Chain Fencing	FFW	Field Fence
FCW	Chain Fencing	FFW	Field Fence

**STATION SCHEDULE**

Station	Easting	Northing	Level(m)
1	XXXXXX	XXXXXX	55.348
2	XXXXXX	XXXXXX	55.349
3	XXXXXX	XXXXXX	55.350
4	XXXXXX	XXXXXX	55.351
5	XXXXXX	XXXXXX	55.352
6	XXXXXX	XXXXXX	55.353
7	XXXXXX	XXXXXX	55.354
8	XXXXXX	XXXXXX	55.355
9	XXXXXX	XXXXXX	55.356
10	XXXXXX	XXXXXX	55.357
11	XXXXXX	XXXXXX	55.358
12	XXXXXX	XXXXXX	55.359
13	XXXXXX	XXXXXX	55.360
14	XXXXXX	XXXXXX	55.361
15	XXXXXX	XXXXXX	55.362
16	XXXXXX	XXXXXX	55.363
17	XXXXXX	XXXXXX	55.364
18	XXXXXX	XXXXXX	55.365
19	XXXXXX	XXXXXX	55.366
20	XXXXXX	XXXXXX	55.367
21	XXXXXX	XXXXXX	55.368
22	XXXXXX	XXXXXX	55.369
23	XXXXXX	XXXXXX	55.370
24	XXXXXX	XXXXXX	55.371
25	XXXXXX	XXXXXX	55.372
26	XXXXXX	XXXXXX	55.373
27	XXXXXX	XXXXXX	55.374
28	XXXXXX	XXXXXX	55.375
29	XXXXXX	XXXXXX	55.376
30	XXXXXX	XXXXXX	55.377
31	XXXXXX	XXXXXX	55.378
32	XXXXXX	XXXXXX	55.379
33	XXXXXX	XXXXXX	55.380
34	XXXXXX	XXXXXX	55.381
35	XXXXXX	XXXXXX	55.382
36	XXXXXX	XXXXXX	55.383
37	XXXXXX	XXXXXX	55.384
38	XXXXXX	XXXXXX	55.385
39	XXXXXX	XXXXXX	55.386
40	XXXXXX	XXXXXX	55.387
41	XXXXXX	XXXXXX	55.388
42	XXXXXX	XXXXXX	55.389
43	XXXXXX	XXXXXX	55.390
44	XXXXXX	XXXXXX	55.391
45	XXXXXX	XXXXXX	55.392
46	XXXXXX	XXXXXX	55.393
47	XXXXXX	XXXXXX	55.394
48	XXXXXX	XXXXXX	55.395
49	XXXXXX	XXXXXX	55.396
50	XXXXXX	XXXXXX	55.397
51	XXXXXX	XXXXXX	55.398
52	XXXXXX	XXXXXX	55.399
53	XXXXXX	XXXXXX	55.400
54	XXXXXX	XXXXXX	55.401
55	XXXXXX	XXXXXX	55.402
56	XXXXXX	XXXXXX	55.403
57	XXXXXX	XXXXXX	55.404
58	XXXXXX	XXXXXX	55.405
59	XXXXXX	XXXXXX	55.406
60	XXXXXX	XXXXXX	55.407
61	XXXXXX	XXXXXX	55.408
62	XXXXXX	XXXXXX	55.409
63	XXXXXX	XXXXXX	55.410
64	XXXXXX	XXXXXX	55.411
65	XXXXXX	XXXXXX	55.412
66	XXXXXX	XXXXXX	55.413
67	XXXXXX	XXXXXX	55.414
68	XXXXXX	XXXXXX	55.415
69	XXXXXX	XXXXXX	55.416
70	XXXXXX	XXXXXX	55.417
71	XXXXXX	XXXXXX	55.418
72	XXXXXX	XXXXXX	55.419
73	XXXXXX	XXXXXX	55.420
74	XXXXXX	XXXXXX	55.421
75	XXXXXX	XXXXXX	55.422
76	XXXXXX	XXXXXX	55.423
77	XXXXXX	XXXXXX	55.424
78	XXXXXX	XXXXXX	55.425
79	XXXXXX	XXXXXX	55.426
80	XXXXXX	XXXXXX	55.427
81	XXXXXX	XXXXXX	55.428
82	XXXXXX	XXXXXX	55.429
83	XXXXXX	XXXXXX	55.430
84	XXXXXX	XXXXXX	55.431
85	XXXXXX	XXXXXX	55.432
86	XXXXXX	XXXXXX	55.433
87	XXXXXX	XXXXXX	55.434
88	XXXXXX	XXXXXX	55.435
89	XXXXXX	XXXXXX	55.436
90	XXXXXX	XXXXXX	55.437
91	XXXXXX	XXXXXX	55.438
92	XXXXXX	XXXXXX	55.439
93	XXXXXX	XXXXXX	55.440
94	XXXXXX	XXXXXX	55.441
95	XXXXXX	XXXXXX	55.442
96	XXXXXX	XXXXXX	55.443
97	XXXXXX	XXXXXX	55.444
98	XXXXXX	XXXXXX	55.445
99	XXXXXX	XXXXXX	55.446
100	XXXXXX	XXXXXX	55.447

**TREE SCHEDULE**

Number	Grass	Species	Height	Note
T.1	2.5	A	0.6	stump
T.2	3.7	B	0.5	medium
T.3	4.1	C	1.0	17
T.4	4.1	D	1.0	17
T.5	5.2	E	1.0	17
T.6	5.2	F	1.0	17
T.7	5.2	G	1.0	17
T.8	5.2	H	1.0	17
T.9	5.2	I	1.0	17
T.10	5.2	J	1.0	17
T.11	5.2	K	1.0	17
T.12	5.2	L	1.0	17
T.13	5.2	M	1.0	17
T.14	5.2	N	1.0	17
T.15	5.2	O	1.0	17
T.16	5.2	P	1.0	17
T.17	5.2	Q	1.0	17
T.18	5.2	R	1.0	17
T.19	5.2	S	1.0	17
T.20	5.2	T	1.0	17
T.21	5.2	U	1.0	17
T.22	5.2	V	1.0	17
T.23	5.2	W	1.0	17
T.24	5.2	X	1.0	17
T.25	5.2	Y	1.0	17
T.26	5.2	Z	1.0	17
T.27	5.2	AA	1.0	17
T.28	5.2	AB	1.0	17
T.29	5.2	AC	1.0	17
T.30	5.2	AD	1.0	17
T.31	5.2	AE	1.0	17
T.32	5.2	AF	1.0	17
T.33	5.2	AG	1.0	17
T.34	5.2	AH	1.0	17
T.35	5.2	AI	1.0	17
T.36	5.2	AJ	1.0	17
T.37	5.2	AK	1.0	17
T.38	5.2	AL	1.0	17
T.39	5.2	AM	1.0	17
T.40	5.2	AN	1.0	17
T.41	5.2	AO	1.0	17
T.42	5.2	AP	1.0	17
T.43	5.2	AQ	1.0	17
T.44	5.2	AR	1.0	17
T.45	5.2	AS	1.0	17
T.46	5.2	AT	1.0	17
T.47	5.2	AU	1.0	17
T.48	5.2	AV	1.0	17
T.49	5.2	AW	1.0	17
T.50	5.2	AX	1.0	17
T.51	5.2	AY	1.0	17
T.52	5.2	AZ	1.0	17
T.53	5.2	BA	1.0	17
T.54	5.2	BB	1.0	17
T.55	5.2	BC	1.0	17
T.56	5.2	BD	1.0	17
T.57	5.2	BE	1.0	17
T.58	5.2	BF	1.0	17
T.59	5.2	BG	1.0	17
T.60	5.2	BH	1.0	17
T.61	5.2	BI	1.0	17
T.62	5.2	BJ	1.0	17
T.63	5.2	BK	1.0	17
T.64	5.2	BL	1.0	17
T.65	5.2	BM	1.0	17
T.66	5.2	BN	1.0	17
T.67	5.2	BO	1.0	17
T.68	5.2	BP	1.0	17
T.69	5.2	BQ	1.0	17
T.70	5.2	BR	1.0	17
T.71	5.2	BS	1.0	17
T.72	5.2	BT	1.0	17
T.73	5.2	BU	1.0	17
T.74	5.2	BV	1.0	17
T.75	5.2	BW	1.0	17
T.76	5.2	BX	1.0	17
T.77	5.2	BY	1.0	17
T.78	5.2	BZ	1.0	17
T.79	5.2	CA	1.0	17
T.80	5.2	CB	1.0	17
T.81	5.2	CC	1.0	17
T.82	5.2	CD	1.0	17
T.83	5.2	CE	1.0	17
T.84	5.2	CF	1.0	17
T.85	5.2	CG	1.0	17
T.86	5.2	CH	1.0	17
T.87	5.2	CI	1.0	17
T.88	5.2	CJ	1.0	17
T.89	5.2	CK	1.0	17
T.90	5.2	CL	1.0	17
T.91	5.2	CM	1.0	17
T.92	5.2	CN	1.0	17
T.93	5.2	CO	1.0	17
T.94	5.2	CP	1.0	17
T.95	5.2	CQ	1.0	17
T.96	5.2	CR	1.0	17
T.97	5.2	CS	1.0	17
T.98	5.2	CT	1.0	17
T.99	5.2	CU	1.0	17
T.100	5.2	CV	1.0	17

**NOTES**

The level and height are approximate. If noted, species should be reported as indicated in this schedule by a qualified expert.

**SCALE BAR**



**ORIENTATION**

